



INVITE



# INVITE

As an architectural firm relocating our office, we had the opportunity to design a new work space that has re-energized the spirits of the architects and designers and fosters cross-studio dialogue. Our 140-person office allows us to practice as a think-thank, promoting collaboration and inspiring innovation through direct human interaction. We are organized into three design studios. This combines the intimacy of a small practice with the extensive resources of a major design firm.

## DESIGN PROBLEM

After two years of occupancy, we learned one of the areas in the office designated as a collaboration zone; the platform, does not yet serve its intended purpose. At present, the space lacks a variety of comfortable and informal furniture options — void of color, texture, and acoustical properties. The absense of ambiance and privacy leaves the space underutilized and less desirable as a break away space for socializing and collaboration.

## DESIGN SOLUTION

We propose a design that evokes an inviting living room with a variety of flexible furniture pieces from Allsteel’s ‘Gather’ collection to encourage team collaboration and offer a sense of privacy from the open studio. The ‘Hedge’ pieces form intimate touch down areas for casual lunches or team brainstorm. The ‘Linger’ lounge chairs offer views of the Fort Point Channel while reading or having informal conversations.



Existing Space

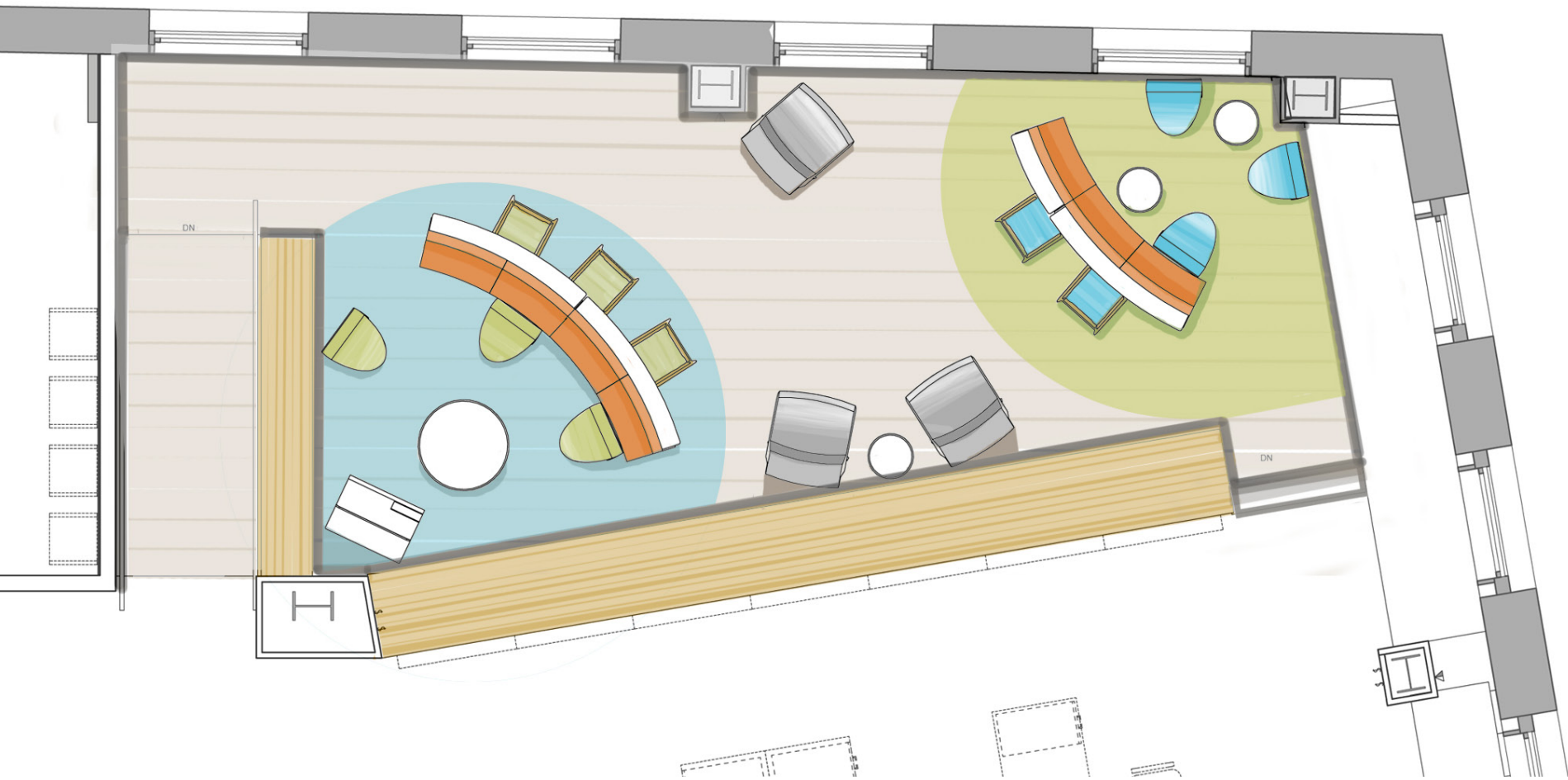

Proposed Floor Plan



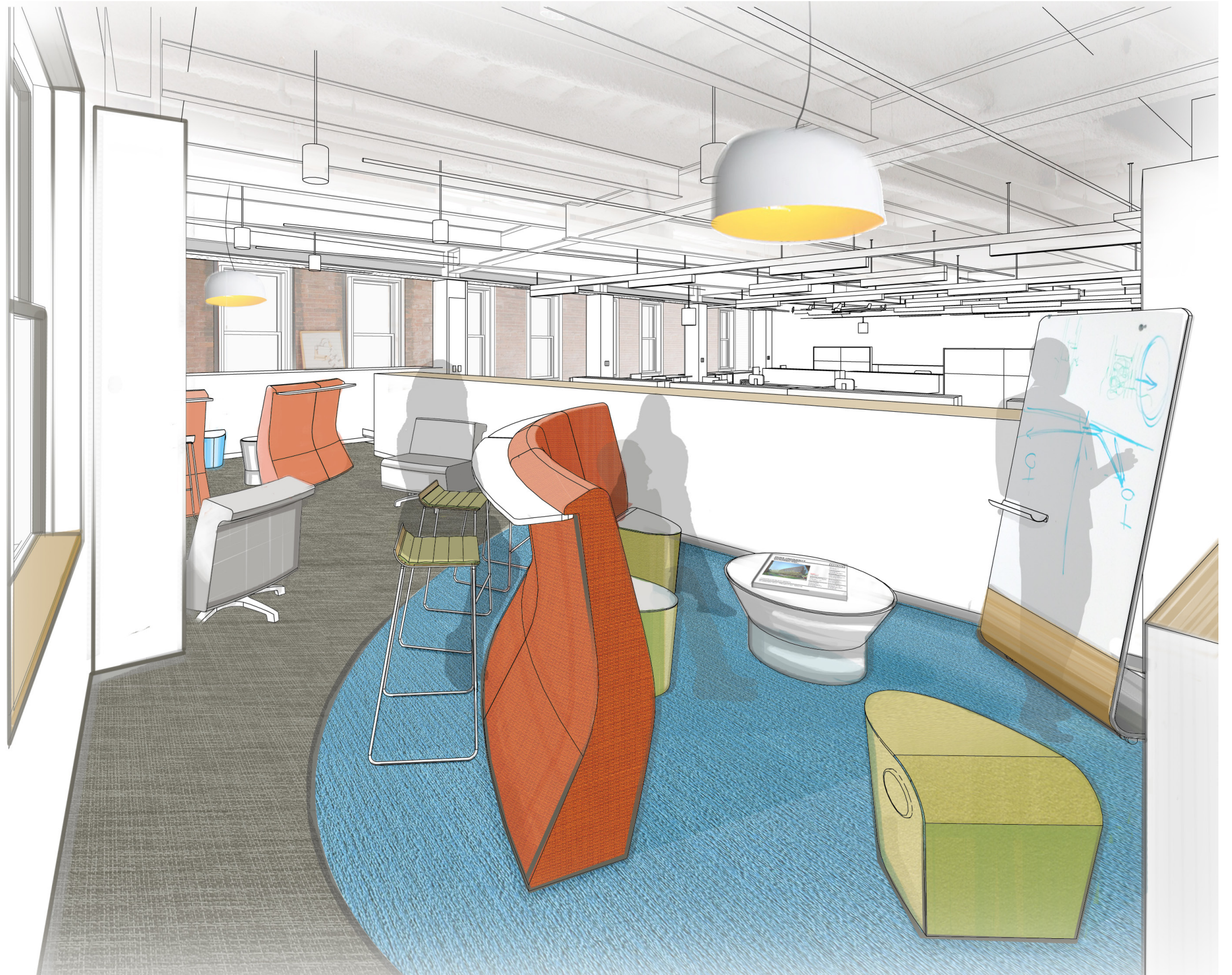

“The office could use a **comfortable and informal lounge** for break-out discussions or having lunch.”



“It would be nice to have  
**lounge furniture** to sit in when  
taking books out of the library  
or reading periodicals.”

2012 OFFICE SURVEY





